

# BLAZE GREEN

Modern wood boiler with perfect combustion



**7** years warranty on the boiler body



Automatic control unit **ecoMAX**



Online management via **ecoNET**

The BLAZE GREEN boiler is the ideal solution for heating homes, recreational and commercial buildings. Thanks to its advanced technology, this boiler stands out as the best product on the market, delivering perfect wood combustion and exceptionally low emissions. Its superior performance makes

it an ideal choice for years to come, particularly in light of potential tightening of emission standards. The BLAZE GREEN boiler incorporates all key design features, ensuring comfortable, economical, and highly efficient operation.

## Benefits of BLAZE GREEN

- Lambda probe for automatic air management
- Certified power adjustability 50–100 %
- Low fuel consumption
- Low emissions (several times lower than required by Emission Class 5)
- 4 patents in one boiler (fuel detection, water mixing, three-way air supply and ray-shaped nozzle)
- Comfortable semi-automatic operation
- Control unit with touch screen
- Insulated stocking chamber
- Lever for cleaning the exchanger
- Possibility of gravity connection
- Compact dimensions

More info about the boiler



## Technical parameters

	BG 10	BG 18	BG 26	BG 33
Nominal output (kW)	10	18	26	33
Adjustable output (kW)	5–10	9–18	13–26	16–33
Efficiency (%)	93	92	92	93
Emission class	5			
Ecodesign	YES			
Energy class	A+			
Log length (cm)	25	33	50	50
Stocking chamber volume (l)	40	80	120	120
Boiler weight (kg)	245	340	440	440
Maximum operating pressure (bar)	3			
Water volume (l)	32	40	55	55

## Dimensions

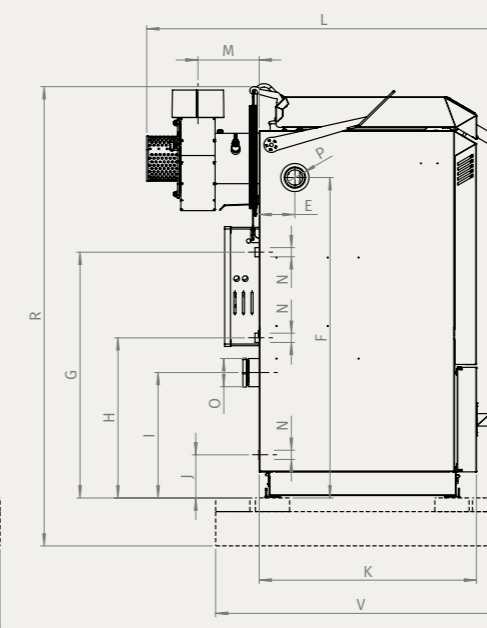

	BG 10 (mm)	BG 18 (mm)	BG 26 (mm)	BG 33 (mm)
A	1200	1200	1200	1200
B	450	530	714	714
C	320	402	568	586
D	Ø149	Ø149	Ø149	Ø149
E	105	105	105	105
F	945	945	945	945
G	750	750	750	750
H	475	475	475	475
I	280	375	375	375
J	100	135	135	135
K	565	635	635	635
L	955	1035	1035	1035
M	180	180	180	180
N	G 1/2"	G 1/2"	G 1/2"	G 1/2"
O	G 6/4"	G 6/4"	G 6/4"	G 6/4"
P	G 6/4"	G 6/4"	G 6/4"	G 6/4"
R	1317	1317	1317	1317
S	496	576	760	760
T	684	684	868	868
U	1202	1202	1202	1202
V	850	850	850	850

## Emission parameters

All BLAZE HARMONY boilers feature significantly lower emission values than those required by the 303-5 and Ecodesign standards. However, the BLAZE GREEN boiler pushes the limits even further when burning lump wood, achieving even lower emission values. The patented beam nozzle, together with automatic combustion control via a lambda probe, ensures very low emission levels. These values are already at the very limit of measurability and are, for example, comparable to condensing gas boilers. And we still burn biomass – a renewable and affordable fuel.

Fuel: wood		BG 10	BG 18	BG 26	BG 33
CO (13 % O <sub>2</sub> )	[mg/m <sup>3</sup> ]	88	21	18	25
OgC/THC (13 % O <sub>2</sub> )	[mg/m <sup>3</sup> ]	3	<1	<1	4
NO <sub>x</sub> (13 % O <sub>2</sub> )	[mg/m <sup>3</sup> ]	83	114	108	126
Dust (13 % O <sub>2</sub> )	[mg/m <sup>3</sup> ]	15	12	14	12